

COPY

421

Licensing Act 2003

Premises Licence

LOCAL AUTHORITY

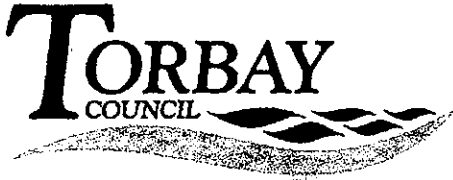

Licensing Section
Torbay Council
Roebuck House
Abbey Road
TORQUAY
DEVON
TQ2 5EJ

Part 1 - Premises Details

POSTAL ADDRESS OF PREMISES, OR IF NONE, ORDNANCE SURVEY MAP REFERENCE OR DESCRIPTION

Vaughans Wine Bar

3 Vaughan Parade, Torquay, Devon, TQ2 5EG.

WHERE THE LICENCE IS TIME LIMITED, THE DATES

Not applicable

LICENSABLE ACTIVITIES AUTHORISED BY THE LICENCE

- any playing of recorded music
- provision of late night refreshment
- the sale by retail of alcohol

THE TIMES THE LICENCE AUTHORISES THE CARRYING OUT OF LICENSABLE ACTIVITIES

Table with 4 columns: Activity (and Area if applicable), Description, Time From, Time To. Rows include F. Playing of recorded music (Indoors), L. Late night refreshment (Indoors), and M. The sale by retail of alcohol for consumption ON and OFF the premises.



Licensing Act 2003
Premises Licence

421

THE OPENING HOURS OF THE PREMISES

Description	Time From	Time To
Monday to Sunday	8:00am	1:00am
Opening hours to be extended on New Years Eve until 0400 on New Years Day. To extend the opening hours until 0200 on the following: all bank holidays and the Friday, Saturday and Sunday immediately preceding each Bank Holiday that falls on a Monday, Easter Saturday, Christmas Eve and Boxing Day.		
No admission to be allowed after midnight.		

WHERE THE LICENCE AUTHORISES SUPPLIES OF ALCOHOL WHETHER THESE ARE ON AND/OR OFF SUPPLIES

- M. The sale by retail of alcohol for consumption ON and OFF the premises

Part 2

NAME (REGISTERED) ADDRESS TELEPHONE NUMBER AND EMAIL (WHERE RELEVANT) OF HOLDER OF PREMISES LICENCE

Terry O'Neil

51 Braddons Hill Road East, Torquay, Devon, TQ1 1HB.
Telephone 01803 402128

REGISTERED NUMBER OF HOLDER, FOR EXAMPLE COMPANY NUMBER, CHARITY NUMBER (WHERE APPLICABLE)

NAME ADDRESS AND TELEPHONE NUMBER OF DESIGNATED PREMISES SUPERVISOR WHERE THE PREMISES LICENCE AUTHORISES THE SUPPLY OF ALCOHOL

Nathan Mark WILLIAMS

51 Braddons Hill Road East, Torquay, Devon, TQ1 1HB.
Telephone 01803 402128

PERSONAL LICENCE NUMBER AND ISSUING AUTHORITY OF PERSONAL LICENCE HELD BY DESIGNATED PREMISES SUPERVISOR WHERE THE PREMISES LICENCE AUTHORISES FOR THE SUPPLY OF ALCOHOL

Licence No. PA0160

Issued by Torbay

Frances Hughes
Assistant Director of Environmental Health and Consumer Protection
3 April 2006



ANNEXES

ANNEXE 1

MANDATORY CONDITION: WHERE LICENCE AUTHORISES SUPPLY OF ALCOHOL

- 1) No supply of alcohol may be made under the premises licence:-
 - (a) at a time where there is no designated premises supervisor in respect of the premises licence , or
 - (b) at a time when the designated premises supervisor does not hold a personal licence or his/her personal licence is suspended.
- 2) Every supply of alcohol under the premises licence must be made or authorised by a person who holds a personal licence.

ANNEXE 2

CONDITIONS CONSISTENT WITH THE OPERATING SCHEDULE

Conditions Transferred from the On Licence

1. Substantial food to be available during all licensing hours.
2. The consumption of intoxicating liquor shall be confined to the premises and the area adjacent thereto, designated under the terms of the Pavement Cafe Permit issued by the local authority, whilst such authority is for the time being in force, providing such persons are seated at tables and the service of all intoxicating liquor is by way of waiter/waitress service.

General

None

The prevention of crime and disorder

1. A clear and legible notice must be erected outside of the premise to indicate;
 - (a) Normal operating hours and regulated entertainment hours and which licensing activities are permitted.
 - (b) Restrictions on admission of children
2. CCTV must be provided internally and externally and maintained in good working order.
3. CCTV tapes must be retained for a minimum of 14 days and made available to the police when requested.
4. SIA door stewards must be used when risk assessments indicates events will require stewards, and during;
 - (a) July -August: 2 Stewarts on Friday and Saturday between 21:00hrs until close.
 - (b) September - June: 1 Stewart on Friday and Saturday between 21:00hrs until close.
5. Employees who are employed to provide security provisions must hold SIA accreditation.
6. SIA Stewards when on duty must display appropriate uniforms or similar.
7. A register of all employees on duty must be kept on the premises.
8. The premises must operate and maintain membership of Nitenet.
9. All drinking glasses must be made from plastic or toughed glass.



ANNEXES continued

10. Drink glasses or bottles must not be removed from the premises.
11. Patrons served outside must be seated and served drinks in toughened or plastic receptacles.
12. Age identification must be sought from any persons appearing to be under the age of 18 years.
13. Bar staff must have sufficient training in respect of underage sales.
14. Appropriate signage of 'any persons appearing to be under the age of 21' must be displayed.
15. Drinks promotions are prohibited.
16. Cigarette machines must be under the supervision of management
17. No sale of cigarettes to persons under the age of 16.

Public Safety

1. A log book must be kept on site for the purpose of recording statutory duties in respect of the Licensing Act 2003.
2. Access must be provided for emergency vehicles at all times.
3. All fixed and portable temporary or permit fixtures and equipment must be maintained in good working order.
4. All fire fighting and detection equipment must be maintained in good working order and written fire risk assessment review as required.
5. Electrical installations must be inspected annually.
6. Electrical appliances must be inspected in accordance with a risk inspection programme.
7. Door and fastenings, gangways, exits and floors must be kept well maintained.
8. Free drinking water must be provided at all times.

The prevention of public nuisance

1. Noise or vibration must not emanate from the premises such as to cause persons in the neighbourhood to be unreasonably disturbed.
2. Noise from the premises will not be audible within any noise sensitive premises with windows open for normal ventilation after 23:00hrs.
3. The DPS or agent of the DPS must assess noise against the following criteria from the boundary to the nearest residential properties, on all sides of the premises:
 - (a) Before 23:00hrs - Noise emanating from the premises will not be clearly distinguishable above other noise.
 - (b) After 23:00hrs - Noise emanating from the premises must not be distinguishable above background levels of noise.
4. Amplified sound must be at all times under the control of the DPS.
5. Noise levels in the premises from musical instruments or amplified equipment must be regulated to protect the hearing of employees and patrons in accordance with appropriate statutory requirements.
6. The placing of refuse, such as bottles into receptacles outside the premises or other similar activities must takes place at times that will prevent disturbance to nearby properties.
7. The handling of beer kegs, bottles, and other similar items will not take place in the late evening, at night and during the early morning, when the noise generated could cause a nuisance particularly outside of the building. The movement of bins must be minimised after 23:00hrs.



ANNEXES continued

8. The DPS must ensure all employees arriving early or leaving avoid causing a disturbance to nearby properties.
9. All doors and windows will be kept shut during entertainment to reduce noise breakout. A management scheme will be in place to ensure this situation remains.
10. Patrons must not stand around talking outside and asked to leave quickly and quietly. This must be announced shortly before closing.
11. Door staff must be positioned at exits to enforce condition 9.
12. Regular maintenance must be undertaken of all plant and mechanical equipment to minimise noise disturbances.
13. No music or speech shall be relayed by external amplified speakers
14. Patrons must be dispersed gradually during a 30 minute period after alcohol sales has ceased.
15. All rubbish must be secured sufficiently in designated areas and provided appropriate means of collecting rubbish generated by patrons.

The protection of children from harm

1. Between 8:00hrs and 20:00 persons below the age of 18 must only be permitted in the upper food area.
2. Persons under the age of 18 when accompanied by an adult can use the Pavement Café areas from 8:00 - 23:00hrs.

ANNEXE 3

The prevention of crime and disorder

1. CCTV systems to be in operation which is of a satisfactory standard and approved as such by the police and a record of that system to be kept for a period not less than 31 days, with the police to have access to that record at any time.
2. All staff employed to serve alcohol to be over the age of 18
3. On nights where the sale of alcohol is to exceed midnight then licensed door staff to be employed as from 21:00 on a nightly basis.

The prevention of public nuisance

1. No amplified recorded music to be performed prior to 11:00hrs inclusive
2. To allow live music and amplified music inside beyond 23:00hrs doors and windows shall be kept shut during entertainment beyond this time. To reduce noise break out. A Management scheme will be in place to ensure this situation remains.
3. To allow live and amplified music to continue inside beyond 00:00hrs double glazing shall be installed to reduce noise breakout.

ANNEXE 4

PLANS

Copy attached to Licence.



VAUGHANS

Fixed Seating

Emergency Access

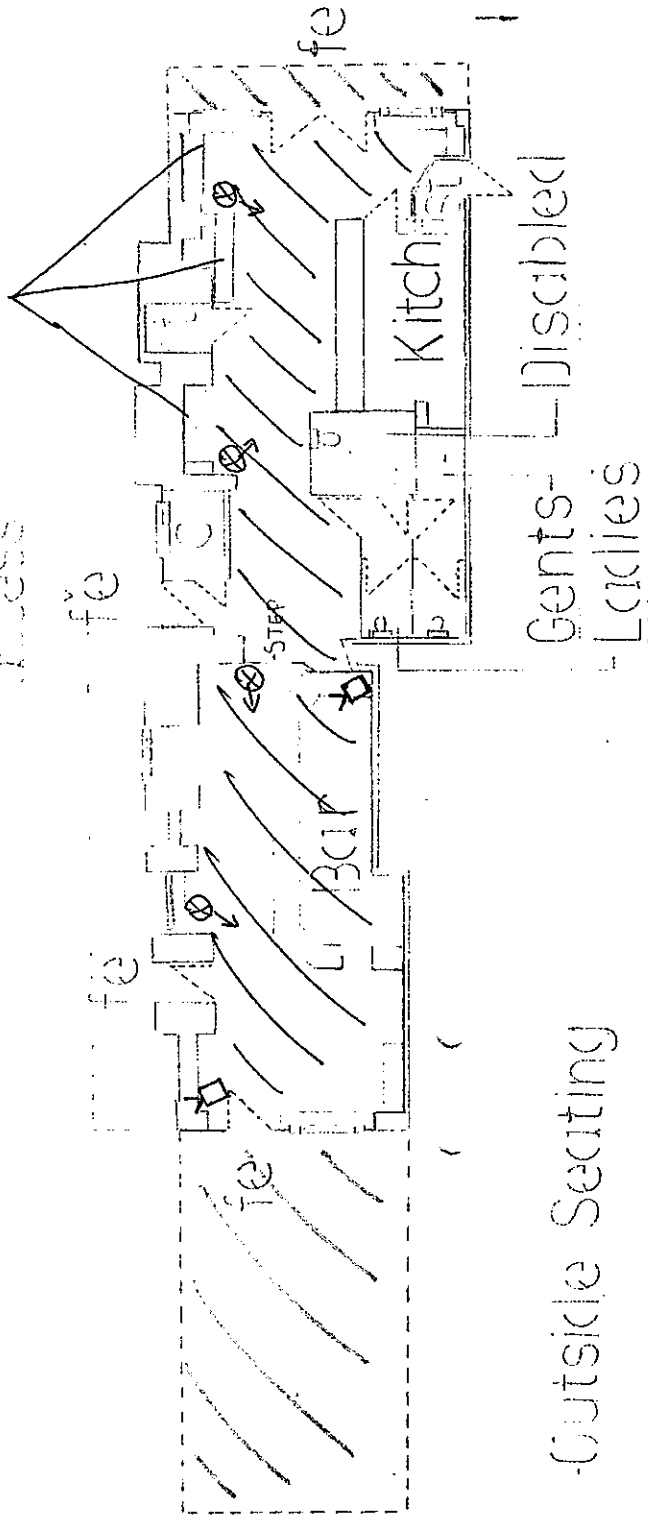

Outside Seating

/// CONSUMPTION & SALE OF ALCOHOL ()

/// CONSUMPTION ONLY ()

⊗ CAMERA

⊗ CCTV MONITORS

st = store
fe = fire exit
C = cellar

Scale 1:100